

High Frequency Current Sensor Series

UL/Approved
 RoHS-Compliant

Part Number	TURNS	Terminals	Specification				Mechanical Dimension							DWG No.
			Rated Current	Sensitivity	Inductance 16K/1V	Terminating Resistance	A	B	C	D	E	F	G	
			1R(A)	S(V/A)	mH	(Ω)	mm							
CS01-1-050	50	1-3	10	1	5	50	18.0	10.0	21.0	5.0	12.5	4.0	0.8	CS01-1
CS01-1-100	100	1-3	24	1	20	100								
CS01-1-200	200	1-3	30	1	80	200								
CS01-1-300	300	1-3	35	1	180	300								
CS01-1-025(2)	25:25	1-2-3	10	1	5	50	18.0	10.0	21.0	5.0	12.5	4.0	0.8	
CS01-1-050(2)	50:50	1-2-3	24	1	20	100								
CS01-1-100(2)	100:100	1-2-3	30	1	80	200								
CS01-1-150(2)	150:150	1-2-3	35	1	180	300								
CS01-2-050	50	1-2	10	1	5	50	18.0	10.0	21.0	4.5	12.5	4.0	0.8	CS01-2
CS01-2-100	100	1-2	24	1	20	100								
CS01-2-200	200	1-2	30	1	80	200								
CS01-2-300	300	1-2	35	1	180	300								
CS01-3-500	500	1-3	40	1	500	500	18.3	10.5	21.4	4.4	12.7	4.0	0.8	CS01-3
CS01-3-750	750	1-3	50	1	1125	750								
CS01-3-1000	1000	3-4	80	1	1800	1000								
CS02-1-050	50	3-4	10	1	5	50	16.9	12.4	17.4	15.0	10.0	4.0	0.7	CS02-1
CS02-1-100	100	3-4	24	1	20	100								
CS02-1-200	200	3-4	30	1	80	200								
CS02-1-300	300	3-4	35	1	180	300								
CS02-1-500	500	3-4	40	1	500	500								
CS02-1-750	750	3-4	50	1	1125	750								
CS02-1-1000	1000	3-4	80	1	1800	1000								

Dimensions : (CS01-2)

Dimensions : CS01-1, CS01-3

Dimensions : CS02-1

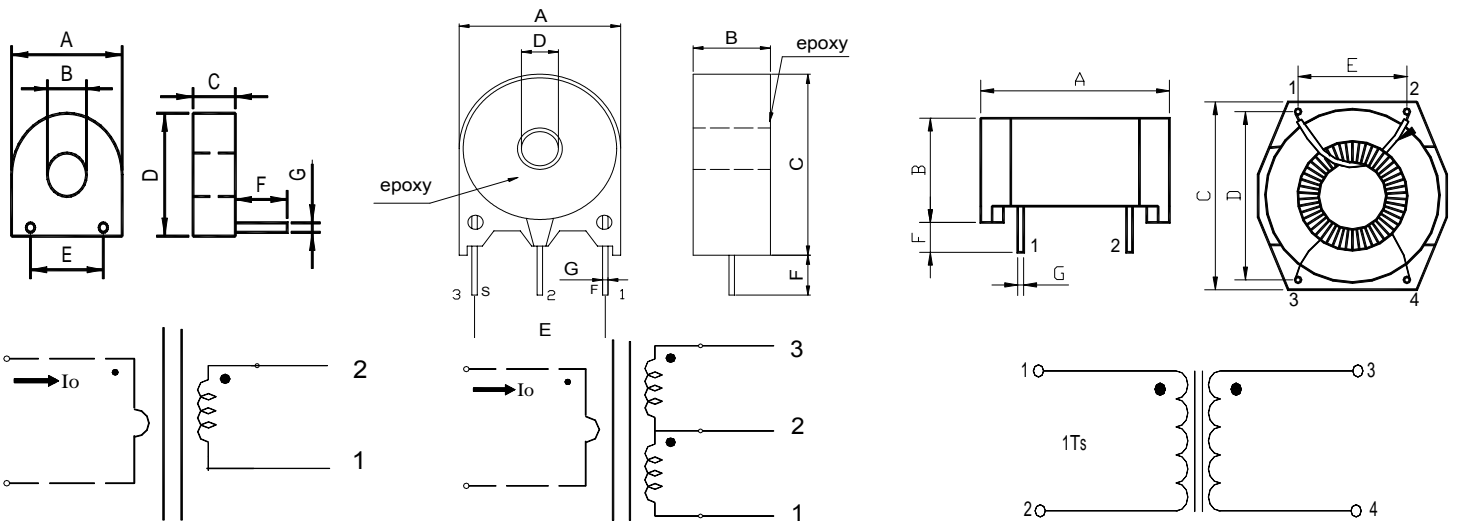

Frequency Range: 20KHZ to 50KHZ and higher.

Operating temperature range: -20°C to +65°C

Storage Temperature Range -25°C to +85°C

H i-POT: 2500VRMS/1min between windings.

Applications:

Feedback Control.

Overload Protection.

Detecting load drop or shutdown.

Proportion output .

Nomination :

CS 01 1 050

→ The Turns of CS01-1 (Np: Ns 1:50 ts)

→ The Size of refered CS01-1

→ The Shape of refered CS01

→ The Current Sensor