

SDO5010 SERIES ~ SMD Power Inductors



RoHS Compliant

PART NUMBERING SYSTEM

SDO	5010	—	1R5M	—	LF
TYPE	DIMENSIONS		INDUCTANCE		LEAD FREE

SHAPES AND DIMENSIONS

UNIT : mm

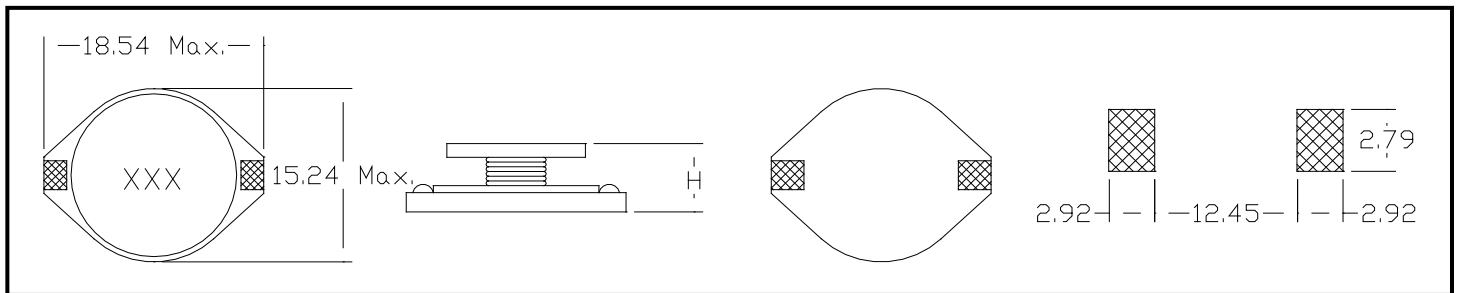

Series	H	Series	H	Series	H
SDO5010A	8.0mm Max.	SDO5010B	7.62mm Max.	SDO5010C	7.11mm Max.

FEATURES

- Very high current ratings - **up to 15 Arms, 30 Asat**
- Inductance ratings from 0.78 to 1000 μ H
- **Exceptionally low DC resistance** thanks to the use of heavier gauge wire
- **Flat top and self-leaded design** for reliable surface mounting
- **Robust temperature deflection** prevents damage during solder reflow
- **RoHS-compliant.** 260°C compatible. Tin-silver over copper terminations.
- Custom versions available

SDO5010 SERIES ~ SMD Power Inductors



RoHS Compliant

SPECIFICATION TABLE

PART NUMBER	INDUCTANCE (μ H)	DCR (m Ω) (Max.)	Isat (A) (Max.)	Irms (A) (Max.)	SRF(MHz) (Ref.)
SDO5010A-R78M-LF	0.78 \pm 20%	2.6	30	15	156
SDO5010A-1R5M-LF	1.5 \pm 20%	4.0	25	15	100
SDO5010A-2R2M-LF	2.2 \pm 20%	6.1	20	12	75
SDO5010A-3R3M-LF	3.3 \pm 20%	8.6	17	10	60
SDO5010A-3R9M-LF	3.9 \pm 20%	10	15	9.0	55
SDO5010A-4R7M-LF	4.7 \pm 20%	14	13	8.4	40
SDO5010A-6R0M-LF	6.0 \pm 20%	17	12	7.5	35
SDO5010A-7R8M-LF	7.8 \pm 20%	18	11	7.5	35
SDO5010A-100M-LF	10 \pm 20%	26	10	6.0	28
SDO5010A-120M-LF	12 \pm 20%	28	8.5	4.4	26
SDO5010A-150M-LF	15 \pm 20%	32	8.0	4.4	20
SDO5010B-220M-LF	22 \pm 20%	47	7.0	3.5	20
SDO5010B-330M-LF	33 \pm 20%	66	5.5	3.0	15
SDO5010B-470M-LF	47 \pm 20%	86	4.5	2.6	9
SDO5010B-680M-LF	68 \pm 20%	130	3.5	2.3	8
SDO5010C-101M-LF	100 \pm 20%	190	3.0	1.8	7
SDO5010C-151M-LF	150 \pm 20%	250	2.6	1.5	6
SDO5010C-221M-LF	220 \pm 20%	380	2.4	1.2	5
SDO5010C-331M-LF	330 \pm 20%	560	1.9	1.0	4
SDO5010C-471M-LF	470 \pm 20%	850	1.4	0.82	3
SDO5010C-681M-LF	680 \pm 20%	1100	1.2	0.72	2.5
SDO5010C-102M-LF	1000 \pm 20%	1800	1.0	0.56	2

1. Inductance tested at 100 kHz, 0.1 Vrms.
2. Isat : DC current at which the inductance drops 10% (typ) from its value without current.
3. Irms : Average current for a 40°C rise above 25°C ambient.
4. Operating temperature range -40°C to +125°C , Electrical specifications at 25°C
5. Packing : 13" reel, machine-ready ,embossed plastic tape (250 parts per full reel).

SD05010 SERIES ~ SMD Power Inductors



RoHS Compliant

PACKAGING SPECIFICATION

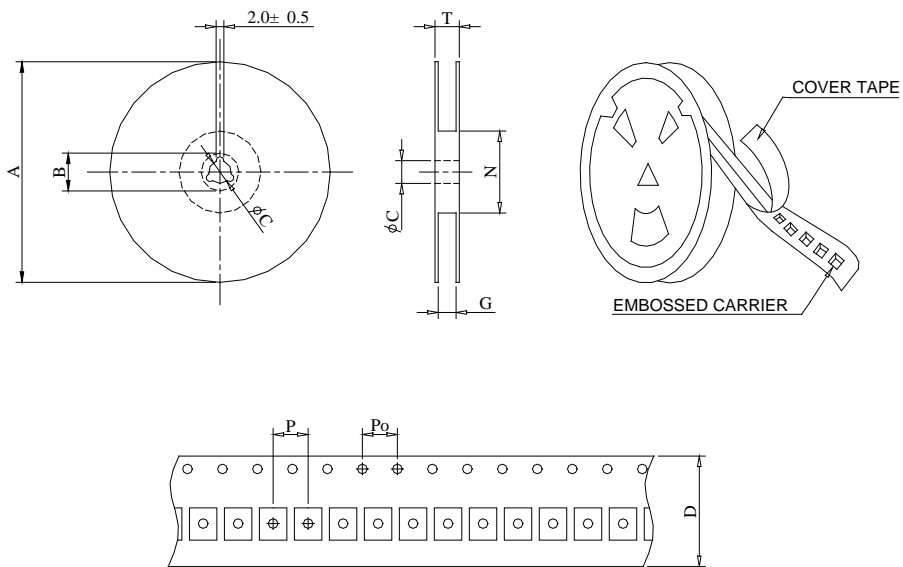

SERIES	STAYLE	Q' TY (PCS)	DIMENSIONS (m/m)								
			A	B±0.8	C±0.5	D±0.5	G±0.3	N±0.2	P±0.1	Po±0.1	T
SD05010	13-16	250	330	-	13	32	32	75	20	4	-